

SW-2003

3x1 S/PDIF Toslink Switcher

User Manual



rev: 200227
Made in Taiwan

TABLE OF CONTENTS

INTRODUCTION.....	1
FEATURES.....	1
PACKAGE CONTENTS	1
SPECIFICATIONS	2
PANEL DESCRIPTIONS.....	3
HARDWARE INSTALLATION	3
CONNECTION DIAGRAM.....	4
WARRANTY.....	5

INTRODUCTION

The **SW-2003 3x1 S/PDIF Toslink Switcher** makes the selection between 3 TOSLINK S/PDIF possible and easy. SW-2003 offers the easiest way to switch between three digital TOSLINK S/PDIF inputs. With the built-in amplifier, digital signal can keep the signal integrity for re-transmission without any signal loss.

FEATURES

- Toslink S/PDIF audio switcher
- Three Toslink S/PDIF audio inputs
- S/PDIF audio supports LPCM, AC3, DTS, bit depth up to 24 bits, sample rate up to 192KHz
- Easy to installation

PACKAGE CONTENTS

- 1x SW-2003
- 1x DC 5V 1A power supply unit
- 1x User Manual

SPECIFICATIONS

Model Name		SW-2003
Technical		
Role of usage		S/PDIF audio splitter
S/PDIF support		LPCM, AC3, DTS
Sample frequency support [Coaxial S/PDIF]		Up to 192kHz
Sample frequency support [Toslink S/PDIF]		Up to 192kHz
ESD protection		Human body model — ±12kV [air-gap discharge] & ±8kV [contact discharge]
Input		3x TOSLINK
Output		1x TOSLINK
RCA connector		50Ω female
Optical audio connector		TOSLINK
Mechanical		
Housing		Metal enclosure
Dimensions [L x W x H]	Model	50 x 50 x 23 mm [1.9" x 1.9" x 0.9"]
	Package	204 x 140 x 48mm [8" x 5.5" x 1.8"]
	Carton	507 x 449 x 460mm [1'6" x 1'4" x 1'5"]
Weight	Model	60g [2.1 oz]
	Package	110g [3.8 oz]
Fixedness		Wall-mounting case
Power supply		5V 1A DC
Power consumption		1 Watts [max]
Operation temperature		0~40°C [32~104°F]
Storage temperature		-20~60°C [-4~140°F]
Relative humidity		20~90% RH [no condensation]

PANEL DESCRIPTIONS

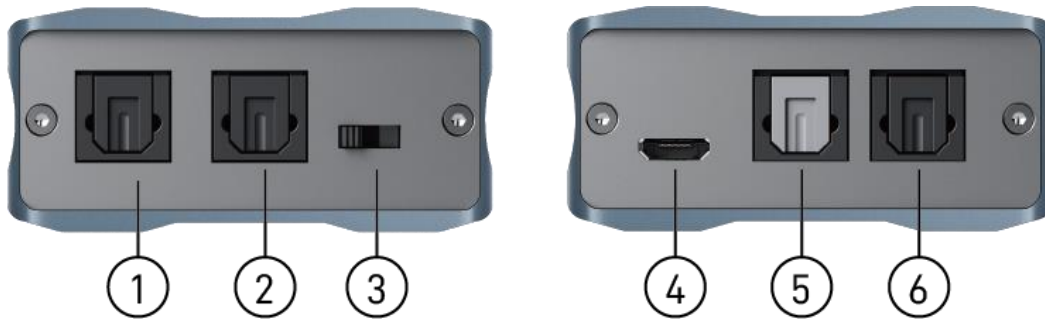

1. **S/PDIF(Toslink) input**
2. **S/PDIF(Toslink) input**
3. **Slide Switch for input selection**
 - [Left] Select Input#1
 - [Middle] Select Input#2
 - [Right] Select Input#3
4. **Power +5V DC**
5. **S/PDIF(Toslink) output**
6. **S/PDIF(Toslink) input**

HARDWARE INSTALLATION

1. Connect your S/PDIF digital audio sources to SW-2003.
2. Connect S/PDIF equipped speaker to TOSLINK connector of SW-2003.
3. Plug in 5V DC power cord to the micro-USB of SW-2003.

CONNECTION DIAGRAM

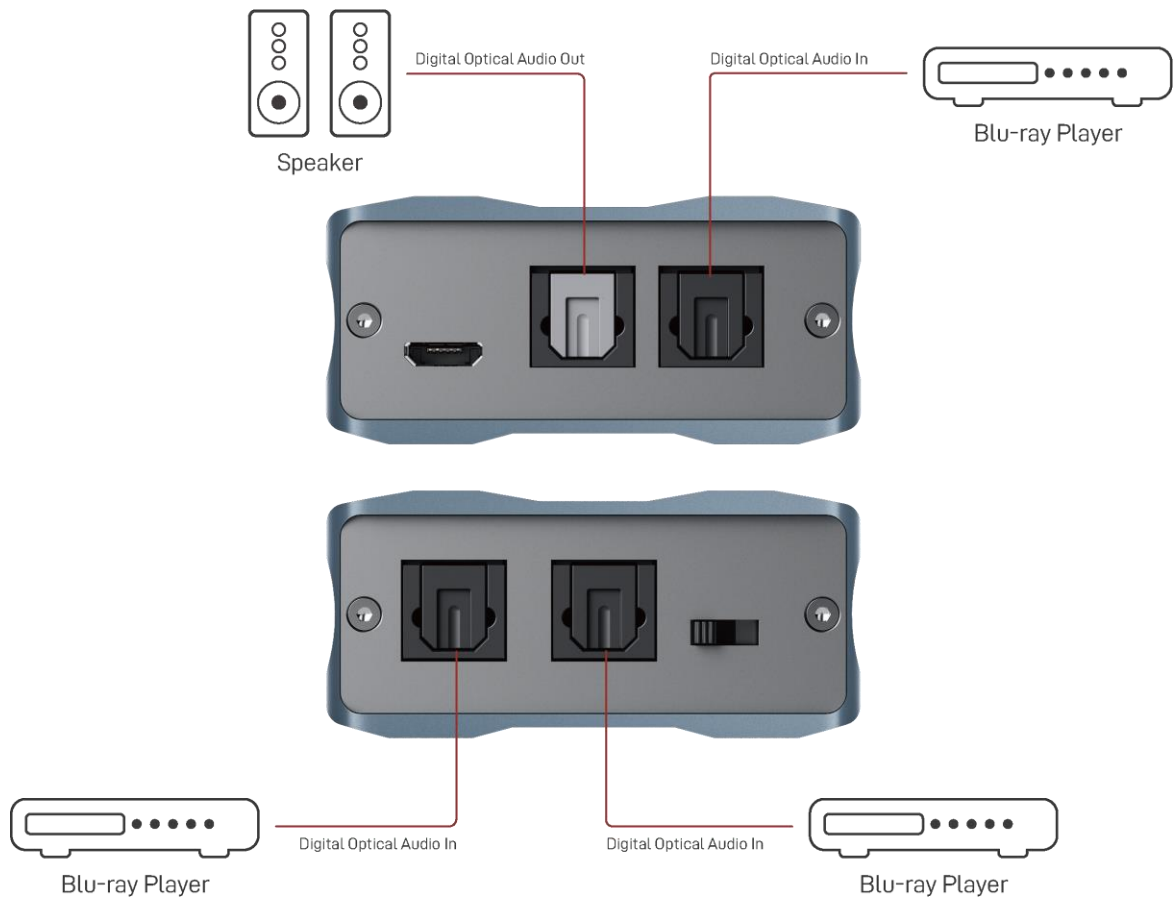

WARRANTY

The SELLER warrants the **SW-2003 3x1 S/PDIF Toslink Switcher** to be free from defects in the material and workmanship for 1 year from the date of purchase from the SELLER or an authorized dealer. Should this product fail to be in good working order within 1 year warranty period, The SELLER, at its option, repair or replace the unit, provided that the unit has not been subjected to accident, disaster, abuse or any unauthorized modifications including static discharge and power surge. This warranty is offered by the SELLER for its BUYER with direct transaction only. This warranty is void if the warranty seal on the metal housing is broken.

Unit that fails under conditions other than those covered will be repaired at the current price of parts and labor in effect at the time of repair. Such repairs are warranted for 90 days from the day of reshipment to the BUYER. If the unit is delivered by mail, customers agree to insure the unit or assume the risk of loss or damage in transit. Under no circumstances will a unit be accepted without a return authorization number.

The warranty is in lieu of all other warranties expressed or implied, including without limitations, any other implied warranty or fitness or merchantability for any particular purpose, all of which are expressly disclaimed.

Proof of sale may be required in order to claim warranty. Customers outside Taiwan are responsible for shipping charges to and from the SELLER. Cables and power adapters are limited to a 30 day warranty and must be free from any markings, scratches, and neatly coiled.

The content of this manual has been carefully checked and is believed to be accurate. However, The SELLER assumes no responsibility for any inaccuracies that may be contained in this manual. The SELLER will NOT be liable for direct, indirect, incidental, special, or consequential damages resulting from any defect or omission in this manual, even if advised of the possibility of such damages. **Also, the technical information contained herein regarding the SW-2003 features and specifications is subject to change without further notice.**